



LIFT GEOMETRY

Radial Lift

DRIVETRAIN

| | |
|--------------------------|--|
| Drive pump controls | Direct mechanical |
| Pump to engine ratio | 1:1 |
| Displacement | 2.14 in ³ (35 cm ³) |
| Flow @ rated engine RPM: | |
| @ 97% efficiency | 25.1 gpm (95 L/min) |
| Charge pressure | 360 psi (24.5 bar) |
| System relief pressure | 5,000 psi (345 bar) |

| | |
|--------------------------|--|
| Drive pump controls | Electro-hydraulic |
| Pump to engine ratio | 1:1 |
| Displacement | 2.14 in ³ (35 cm ³) |
| Flow @ rated engine RPM: | |
| @ 97% efficiency | 25.1 gpm (95 L/min) |
| Charge pressure | 362 psi (24.5 bar) |
| System relief pressure | 5,220 psi (360 bar) |

| | |
|---|---|
| Drive motors: | |
| Max. displacement | 19.8 in ³ (325 cm ³) |
| Displacement: | |
| High speed | 12.2 in ³ (200 cm ³) |
| Motor RPM @ high idle and 97% efficiency: | |
| 2-speed | 443 |
| Motor torque @ max. displacement and relief pressure, calculated @ 5,000 psi (345 bar): | 1,315 lb-ft (1 783 N-m) |

| | |
|---------------|---------------------|
| Travel speed: | |
| Low range | 7.4 mph (11.9 kph) |
| High range | 10.8 mph (17.4 kph) |

| | |
|-------------|------------------------------|
| Final drive | Single-reduction chain drive |
|-------------|------------------------------|

| | |
|------------------|---------------------|
| Drive chain: | |
| Size | ASA #80 |
| Tensile strength | 21,000 lb (93.4 kN) |

| | |
|--|-------------------------|
| Axles: | |
| Torque @ max. displacement and relief pressure | 4,381 lb-ft (5 940 N-m) |
| Diameter | 2.0 in (50.8 mm) |
| Length | 15.1 in (384.0 mm) |

| | |
|----------------|---|
| Parking brake: | |
| Type | Spring-applied, hydraulic release multiple disc. |
| Engagement | Depress on/off brake button on handle or instrument panel, raise seat bar, get off seat or stop engine. |

ELECTRICAL

| | |
|------------|--|
| Alternator | 120 amp |
| Starter | 2.68 hp (2.0 kW) |
| Battery | 12-volt low-maintenance 950 cold-cranking amps @ 0° F (-18° C°) |

OPERATOR ENVIRONMENT

ROPS/FOPS Level 1 canopy w/ side screens; Keyed start ignition; Tilt ROPS/FOPS; Rear window w/ emergency escape; Suspension Seat, vinyl w/ 2 in (51 mm) retractable 3 point lap seat belt; Hand and foot throttle; Alarm package – back-up and horn; Rearview mirror; Headliner;

Dome Light; Top window; Cup holder; 12V Power plug socket; Foot rest; Seat pocket; Padded seat bar w/ integral armrests; Loader control lockout system; Electric parking brake control; Operator's compartment floor cleanout; Proportional auxiliary hydraulic control – on joystick; Advanced Instrument Cluster w/ digital hour meter, tachometer, fuel level LCD bar graph w/ alarm, diagnostic features and security lockout.

Warning lights with alarms:
Engine coolant temperature; Engine oil pressure; Engine malfunction; Hydraulic charge pressure; Hydraulic filter restriction; Hydraulic oil temperature: Critical system stop, Engine system, Hydraulic system, Electrical and diagnostic system.

Warning alarms:
Battery voltage – plus display; Oil service.

Indicator light:
Engine preheat; Parking brake;
Seat bar reminder.

OPERATING WEIGHT

Unit equipped w/ open cab; 165 lb operator; 66 in Dirt & Foundry bucket; full of fuel; 10 x 16.5 tires: 6,270 lb (2 842 kg)

Shipping weight 5,970 lb (2 705 kg)

| | |
|--------------------------|------------------|
| Add-on weights: | |
| Side cab glass | 47 lb (21.3 kg) |
| Polycarbonate cab door | 74 lb (33.6 kg) |
| Glass cab door w/ wiper | 134 lb (60.8 kg) |
| Suspension seat | 22 lb (10.0 kg) |
| Additional counterweight | 140 lb (63.5 kg) |

HYDRAULICS

| | |
|---------------------|------|
| Implement pump type | Gear |
|---------------------|------|

| | |
|----------------|--|
| Displacement: | |
| Standard aux. | 1.7 in ³ (27.8 cm ³) |
| High-flow aux. | 0.84 in ³ (13.8 cm ³) |

Standard flow @ rated engine RPM:
@ 100% efficiency 20.6 gpm (78.0 L/min)

Optional high-flow @ rated engine RPM:
@ 100% efficiency 30.7 gpm (116.2 L/min)

| | |
|-----------------------|-------------------------------------|
| Loader control valve: | |
| Type | 3 spool/open center/series - series |
| Relief pressure | 3,050 psi (210 bar) |

| | |
|------------------------|---------------------|
| Port relief pressures: | |
| Loader raise | 3,263 psi (225 bar) |
| Bucket curl | 3,770 psi (260 bar) |
| Bucket dump | 1,160 psi (80 bar) |

| | |
|------------------|---------------|
| Hydraulic lines: | |
| Tubing | 37° JIC Flare |
| Loop hoses | SAE 100 R19 |

| | |
|-----------------------|--|
| Hydraulic oil cooler: | |
| Number of fins | 9.5 per inch (3.74 per cm) |
| Number of tube rows | 7 |
| Area | 108 in ² (700 cm ²) |

| | |
|------------------|-----------------------|
| Hydraulic filter | Beta (4) = 75/spin-on |
|------------------|-----------------------|

ENGINE

| | |
|-------|--------------------|
| Model | Perkins 404F-E22TA |
|-------|--------------------|

| | |
|-------------------------|-------------------|
| Emissions Certification | Stage 5 emissions |
|-------------------------|-------------------|

| | |
|------|------------------------------|
| Type | Diesel 4-stroke, Turbo. D.I. |
|------|------------------------------|

| | |
|-----------|---|
| Cylinders | 4 |
|-----------|---|

| | |
|-------------|---------------------------------|
| Bore/Stroke | 3.31 x 3.94 in (84 x 100 mm) |
|-------------|---------------------------------|

| | |
|--------------|-------------------------------|
| Displacement | 135.2 in ³ (2.2 L) |
|--------------|-------------------------------|

| | |
|----------------|--|
| Fuel injection | Direct, high pressure common rail – HPCR |
|----------------|--|

| | |
|------|-----------|
| Fuel | #2 Diesel |
|------|-----------|

| | |
|--------------|-------------------------|
| Fuel filter: | |
| Pre-filter | Beta (30) = 200/spin-on |
| Main filter | Beta (4) = 20/spin-on |

| | |
|------------|--|
| Air intake | Turbocharged w/ waste gate and intercooled w/ external EGR |
|------------|--|

| | |
|---------------------------------|--|
| Exhaust aftertreatment: | |
| Diesel Oxidation Catalyst – DOC | |
| Diesel Particulate Filter – DPF | |

| | |
|---------|--------|
| Cooling | Liquid |
|---------|--------|

| | |
|---------------------|-------------|
| Engine speeds | RPM |
| High idle – no load | 2825 +/- 25 |
| Rated – full load | 2800 |
| Low idle | 1200 +/- 50 |

| | |
|------------------------------------|-----------------|
| Horsepower @ 2800 RPM – SAE J1349: | |
| Gross | 67 hp (50.0 kW) |
| Net | 64 hp (47.7 kW) |

| | |
|------------------------|---------------------|
| Peak torque @ 1800 RPM | 153 lb-ft (208 N-m) |
|------------------------|---------------------|

| | |
|----------------|---|
| Radiator: | |
| Core type | Aluminum bar and plate |
| Core size area | 265 in ² (0.171 m ²) |
| Rows of tubes | 20 |
| Cap pressure | 16 +/- 2 psi (1.10 +/- 0.14 bar) |

| | |
|----------|------------------|
| Fan: | |
| Diameter | 17.7 in (450 mm) |
| Ratio | 0.89:1 |

| | |
|-------------|-----------------------|
| Water pump: | |
| Style | Centrifugal |
| Flow | 14.7 gpm (55.5 L/min) |

| | |
|-------------------------|--------------------------------|
| Engine lubrication pump | Pressure feed w/ Trichoid pump |
|-------------------------|--------------------------------|

| | |
|-------------------------------|-----|
| Pump operating angle ratings: | |
| Side to side | 35° |
| Bucket up | 35° |
| Bucket Down | 35° |

HYDRAULICS CONT.

| | |
|-------------------|---------------------|
| Lift cylinders: | |
| Bore diameter | 2.25 in (57.2 mm) |
| Rod diameter | 1.50 in (38.1 mm) |
| Stroke | 31.69 in (804.9 mm) |
| Closed length | 45.59 in (1 158 mm) |
| Bucket cylinders: | |
| Bore diameter | 2.75 in (69.9 mm) |
| Rod diameter | 1.38 in (34.9 mm) |
| Stroke | 16.14 in (410 mm) |
| Closed length | 24.02 in (610 mm) |

SERVICE CAPACITIES

| | |
|------------------------|-------------------|
| Fuel tank | 19.5 gal (73.8 L) |
| Engine oil w/ filter | 7.5 qt (7.1 L) |
| Hydraulic system: | |
| Reservoir | 5.0 gal (18.9 L) |
| Total | 8.5 gal (32.2 L) |
| Chain tanks – per side | 1.95 gal (7.4 L) |

PERFORMANCE SPECS

| | |
|---|---------------------|
| Rated operating capacity – ROC*: | |
| 50% of tipping load | 1,750 lb (790 kg) |
| w/ additional counterweight | 1,850 lb (839 kg) |
| Tipping load* | 3,500 lb (1 588 kg) |
| Breakout forces @ 3,150 psi (217 bar)*: | |
| Bucket cylinders | 7,270 lb (32.3 kN) |
| Lift cylinders – tip limit | 3,810 lb (16.9 kN) |
| Cycle times: | |
| Raise | 3.4 sec |
| Lower | 1.9 sec |
| Dump | 2.6 sec |
| Roll back | 1.9 sec |

NOTE: *Measured using 66 in (1.68 m) foundry/ excavating bucket.

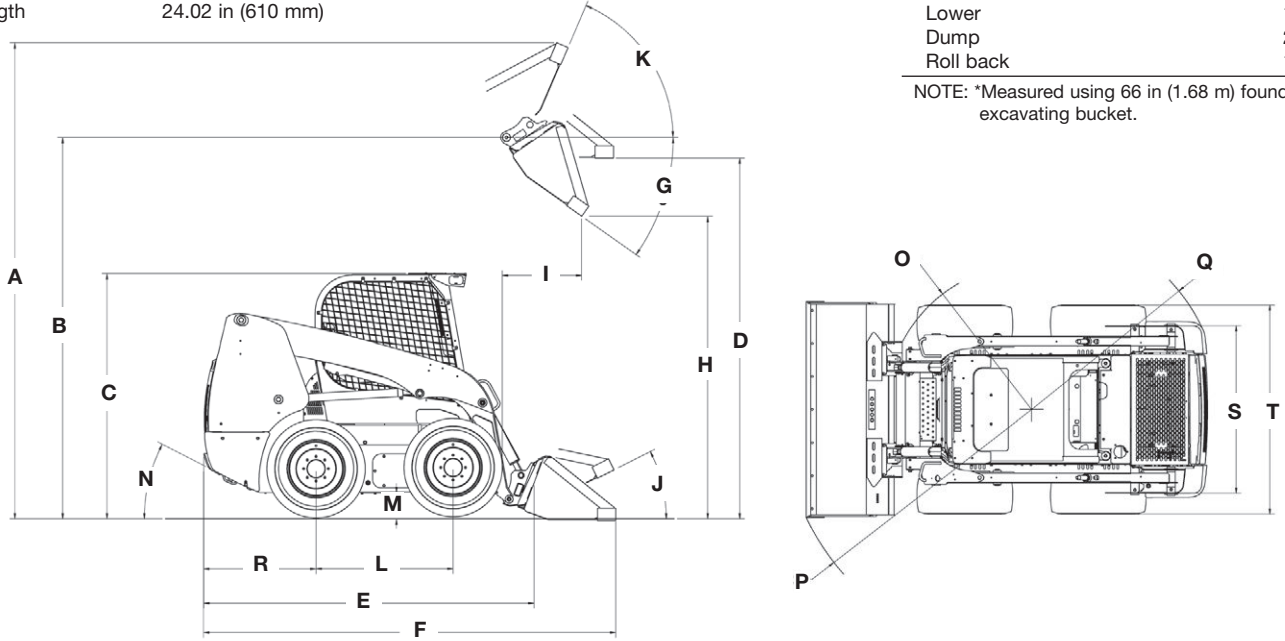

Line drawings are for illustrative purpose only and may not be exact representation of unit.

DIMENSIONS

| | |
|--|--------------------------|
| A. Overall operating height: | |
| with foundry/excavating bucket | 153.4 in (3.90 m) |
| with low profile bucket | 157.3 in (4.00 m) |
| with low profile extended bucket | 162.2 in (4.12 m) |
| Height to: | |
| B. Bucket hinge pin | 122.0 in (3.10 m) |
| C. Top of ROPS | 77.7 in (1.97 m) |
| D. Bottom of level bucket, fully raised | 115.2 in (2.93 m) |
| Overall length: | |
| E. without attachment with coupler | 105.7 in (2.69 m) |
| F. with foundry/excavating bucket on ground | 130.1 in (3.31 m) |
| with low profile bucket | 134.3 in (3.41 m) |
| with low profile extended bucket | 139.3 in (3.54 m) |
| G. Maximum dump angle | 39.6° |
| H. Dump height: | |
| with foundry/excavating bucket | 97.2 in (2.47 m) @ 39.6° |
| with low profile bucket | 94.6 in (2.40 m) @ 39.6° |
| I. Dump reach at maximum height with low profile bucket | 24.4 in (0.62 m) @ 39.6° |
| Maximum attachment rollback: | |
| J. Bucket on ground | 31.6° |
| K. Bucket at full height | 98.6° |
| L. Wheelbase | 44.4 in (1.13 m) |
| M. Ground clearance – bottom of belly pan | 7.0 in (0.18 m) |
| N. Angle of departure | 23.0° |
| Clearance circle: | |
| O. without bucket | 52.2 in (1.33 m) |
| P. with 66 in (1.68 m) foundry/excavating bucket in carry position | 79.3 in (2.02 m) |
| with 66 in (1.68 m) low profile bucket on ground | 83.1 in (2.11 m) |
| with 66 in (1.68 m) extended low profile on ground | 87.7 in (2.23 m) |
| Q. Clearance circle rear | 62.9 in (1.60 m) |
| R. Rear axle to bumper | 36.4 in (0.92 m) |
| S. Tread over gauge with spec lines | 53.9 in (1.37 m) |
| T. Over the tire width spec tires | 64.6 in (1.64 m) |

OPTIONAL BUCKETS

| Type | Width | Weight | Heaped Capacity |
|---|----------------|-----------------|---|
| Dirt & Foundry | 66 in (1.68 m) | 385 lb (175 kg) | 14.8 ft ³ (0.42 m ³) |
| | 72 in (1.83 m) | 420 lb (190 kg) | 16.2 ft ³ (0.46 m ³) |
| | 78 in (1.98 m) | 440 lb (200 kg) | 17.7 ft ³ (0.50 m ³) |
| Low Profile | 66 in (1.68 m) | 440 lb (200 kg) | 13.4 ft ³ (0.38 m ³) |
| | 72 in (1.83 m) | 480 lb (218 kg) | 14.8 ft ³ (0.42 m ³) |
| Low Profile Extended | 66 in (1.68 m) | 470 lb (214 kg) | 15.9 ft ³ (0.45 m ³) |
| | 72 in (1.83 m) | 510 lb (232 kg) | 17.7 ft ³ (0.50 m ³) |
| | 78 in (1.98 m) | 540 lb (245 kg) | 19.1 ft ³ (0.54 m ³) |
| | 84 in (2.13 m) | 575 lb (262 kg) | 20.5 ft ³ (0.58 m ³) |
| Light Material | 72 in (1.83 m) | 475 lb (216 kg) | 23.3 ft ³ (0.66 m ³) |
| | 84 in (2.13 m) | 540 lb (245 kg) | 27.5 ft ³ (0.78 m ³) |
| Manure & Slurry | 72 in (1.83 m) | 480 lb (218 kg) | 19.1 ft ³ (0.54 m ³) |
| Heavy-Duty | 72 in (1.83 m) | 510 lb (230 kg) | 14.1 ft ³ (0.40 m ³) |
| | 78 in (1.98 m) | 530 lb (240 kg) | 15.5 ft ³ (0.44 m ³) |
| Heavy-Duty Extended with SmartFit Teeth | 72 in (1.83 m) | 667 lb (303 kg) | 17.4 ft ³ (0.49 m ³) |
| | 78 in (1.98 m) | 697 lb (316 kg) | 18.9 ft ³ (0.54 m ³) |

STANDARD EQUIPMENT

OPERATOR ENVIRONMENT

See page 1

ENGINE

Charged Air Cooler (CAC)
Dual element air cleaner
Organic Acid Technology (OAT)
Anti-freeze solution to -34° F
Fuel tank – 20 gal (U.S.)
Over and under radiator and oil cooler
3-stack after cooler/radiator/oil cooler configuration
Glow plugs
Integral engine oil cooler
Fuel filter with water trap
925 CCA 12V battery
Master electrical disconnect

DRIVETRAIN

2-speed hydrostatic four wheel drive
ASA #80 drive chain
SAHR disc parking brake

HYDRAULICS

Auxiliary hydraulics:
@ 3,050 psi (210 bar) – 20.6 gpm
(78.0 L/min)
6 micron oil filtration system
3-spool loader control valve
Auxiliary hydraulic disconnects, ISO flat-face – connect-under-pressure with case drain
Hydraulic circuit pedal lock
Auxiliary function lockout override
Loader lift lockout override
Heavy-duty hydraulic oil cooler
Loader arm float position
Loader function lockout system

LOADER

Auxiliary front electric control
Manual attachment coupler
Radial lift geometry
Loader lift arm support strut

TIRES

10 X 16.5 Heavy duty

OTHER STANDARD FEATURES

LED lights – 2 front, 2 side, 2 rear flood
Pre-wired for rotating beacon
Lockable service access hood
Single-point daily service
Rear tail lights
Remote oil and fuel filters
Block heater
Debris ingress sealing
Mounting points for add-on counterweights

TELEMATICS

CASE SiteWatch™ Telematics – includes hardware and a 5-yr data subscription
SiteConnect Module providing remote diagnostics capability

OPTIONAL AND FIELD INSTALLED EQUIPMENT

OPERATOR ENVIRONMENT

Enclosed cab:
Fully sealed and pressurized – FSP
Glass door with wiper and washer
Sliding side windows – removable
Heater and air conditioner
AM/FM Bluetooth radio with 2 speakers
Keyless start ignition
8 in Color LCD Display
Economy Mode (auto idle shutdown)
Auto Engine Protection Shutdown
Electro-hydraulic controls:
For drive/steering, loader functions
Switchable between H and ISO patterns
Adjustable sensitivity of controls
Mechanical hand controls
Hand and foot controls:
Hand controls the loader drive function and foot controls the bucket and boom
Deluxe cloth, air suspension seat, with heater and lumbar support
Demolition cab door with polycarbonate
Ignition Timeout
Machine Settings User Access Levels
Operator Security Codes
Auto Idle settings

HYDRAULICS

High-flow auxiliary hydraulics – combined:
@ 3,050 psi (210 bar) – 30.7 gpm
(116.2 L/min)
Hydraulic one-way self-leveling
Auto Ride Control
Ride control

LOADER

Hydraulic attachment coupler

DRIVETRAIN

Creep Speed Mode (on EH machines only)

OTHER

Language decals
Buckets – see page 3
Bolt-on bucket cutting edges
Special paint
Rotating beacon
4 Point Lift Hook

SERVICE PARTS

3 inch (76.2 mm) retractable seat belt
Bolt-on heavy-duty bucket teeth
Second auxiliary hydraulics
Add-on counterweights
Road lights
Four-corner LED strobe
Fire Extinguisher
Tamper Resistant Front Door Bracket
Bucket Cylinder Guards
Single Point Lift Hook
Aspirator
Attachment Hose Guide Kit
Drawbar

CaseCE.com

©2023 CNH Industrial America LLC. All rights reserved. CASE is a trademark registered in the United States and many other countries, owned by or licensed to CNH Industrial N.V., its subsidiaries or affiliates. CNH Industrial Capital is a trademark in the United States and many other countries, owned by or licensed to CNH Industrial N.V., its subsidiaries or affiliates. Printed in U.S.A. Contains 10% post-consumer fiber.

IMPORTANT: CASE Construction Equipment Inc. reserves the right to change these specifications without notice and without incurring any obligation relating to such change. Availability of some models and equipment builds vary according to the country in which the equipment is used. The illustrations and text may include optional equipment and accessories and may not include all standard equipment. Your CASE dealer/distributor will be able to give you details of the products and their specifications available in your area.



CASE Construction Equipment is biodiesel-friendly. NOTE: All engines meet current EPA emissions regulations. All specifications are stated in accordance with SAE Standards or Recommended Practices, where applicable.



Always read the Operator's Manual before operating any equipment. Inspect equipment before using it, and be sure it is operating properly. Follow the product safety signs and use any safety features provided.

Form No. CCE202310SR175B

Replaces Form No. CCE202103SR175B

MIMICO

0800 64 64 26 | enquiries@mimico.co.nz | www.mimico.co.nz